



立即
在MyBosch上
为您的电器注册，
免费获得以下福利：
[bosch-home.cn/
welcome](https://bosch-home.cn/welcome)



Clever**Mixx** 手持式料理机

MFQC..CN

[zh]	使用说明书	手持式料理机	3
[en]	Instruction manual	Hand Mixer	9

使用产品前请仔细阅读本使用说明书，并请妥善保管

Intended use

Read and follow the instruction manual carefully and keep for later reference! Enclose these instructions when you give this appliance to someone else.

If the instructions for correct use of the appliance are not observed, the manufacturer's liability for any resulting damage will be excluded.

This appliance is intended for domestic use only. Use the appliance only for processing normal amounts of food and for normal amounts of time for domestic use.

The appliance is suitable for stirring, beating and mixing soft foodstuffs and liquids, and for kneading soft dough. The appliance should not be used for processing other substances or objects.

This appliance can be used by persons with reduced physical, sensory or mental capabilities or lack of experience and/or knowledge if they have been given supervision or instruction concerning use of the appliance in a safe way and if they understand the hazards involved. Keep children away from the appliance and connecting cable and do not allow them to use the appliance. Do not let children play with the appliance. Cleaning and user maintenance must not be performed by children.

Safety instructions

Risk of electric shock and fire!

Only use the appliance indoors at room temperature and up to 2000 m above sea level. Do not place the appliance on or near hot surfaces, e.g. hobs.

Connect and operate the appliance only in accordance with the specifications on the rating plate. Do not use the appliance if the power cord and/or appliance are damaged. Only our customer service may repair the appliance, e.g. by replacing a damaged power cord, in order to avoid hazards. The mains cable must not come into contact with hot parts or be pulled across sharp edges.

Never immerse the base unit in water or place it in the dishwasher. Do not steam-clean the appliance. Do not use the appliance with damp hands.

After each use, whenever the appliance is unsupervised, prior to assembly, prior to disassembly, prior to cleaning and in the event of an error, the appliance must always be disconnected from the mains.

⚠ Risk of injury!

Never connect the appliance to timer switches or remote-controllable sockets. If the power is interrupted, the appliance remains switched on and restarts when the power is restored. Switch off the appliance immediately. Never leave the appliance unattended while it is switched on! Never leave the appliance switched on for longer than is necessary to process the ingredients. Immediately after using the appliance, wait for it to stop. Before replacing accessories or additional parts which move during operation, the appliance must be switched off and disconnected from the power supply. Do not operate the appliance at idle speed. Keep hands clear of rotating parts. Protect long hair or loose items of clothing to prevent them from becoming caught in the rotating tools. Use the appliance only with genuine parts and accessories. Only insert tools of the same type (e.g. 2x kneading hooks) in pairs.

⚠ Risk of scalding!

Take care when processing hot food. Hot food may splash during processing.

⚠ Important!

It is essential to clean the appliance as described after each use or after it has not been used for an extended period.

➔ “Care and daily cleaning” 参见第 6 页

Contents

Intended use.....	3
Safety instructions.....	3
Overview.....	5
Before using for the first time	5
Tools.....	6
Operation	6
Care and daily cleaning	6
Recipes.....	7
Disposal.....	8
Guarantee.....	8

Congratulations on the purchase of your new Bosch appliance. You can find further information about our products on our web page.

原产地:

斯洛文尼亚

总经销商:

博西家用电器 (中国) 有限公司
南京市中山路129号中南国际大厦20、21楼

执行标准:

GB 4706.1-2005

家用和类似用途电器的安全 第1部分:
通用要求

GB 4706.30-2008

家用和类似用途电器的安全 厨房机械的特
殊要求

全国统一客户服务热线:

4008855888

客户服务电子邮箱:

careline.china@bshg.com

公司网站:

www.bosch-home.cn

技术数据:

电气连接 (电压 - 频率)	220-240 V~ 50/60 Hz
额定功率 MFQCP..CN MFQCM..CN	375 W 400 W
尺寸 (高 x 宽 x 深)	153 x 200 x 73 毫米

这些操作说明涉及到各种型号。图示页上有不同型号的概述。 → Fig. C

产品概览

→ Fig. A

Base unit

- 1 **Ejector button**
- 2 **On/Off switch (multi-level)**
 - a 0 = Appliance switched off
 - b 1 = Lowest speed
 - c 4 = Highest speed
 - d M = Instantaneous switching (highest speed)
- 3 **Mains cable**
- 4 **Apertures for inserting the tools**
 - a Large aperture (with 4 indentations)
 - b Small aperture

Tools*

- 5 **Stirring whisks (x2)**
- 6 **Turbo stirring whisks (x2)**
- 7 **Kneading hooks (x2)**
- 8 **Universal cutter***
(separate instruction manual)

* Depending on the model

With the universal cutter, you can use the appliance at full power. If the universal cutter is not included with the hand blender, it can be ordered from customer service (order no. 12011748).

Before using for the first time

Before the new appliance can be used, it must be fully unpacked, cleaned and checked.

Caution!

Never operate a damaged appliance!

- Remove the base unit and all accessories from the packaging.
- Remove the packaging material that is present.
- Check all parts for completeness. → Fig. A
- Inspect all parts for visible damage.
- Thoroughly clean and dry all parts before using for the first time. → “Care and daily cleaning” 参见第 6 页

Tools**Notes:**

- The stirring whisks are not suitable for processing heavy dough.
- The maximum processing quantity is 500 g of flour and ingredients.

Stirring whisks or turbo stirring whisks depending on the model

Suitable for sauces, beaten egg whites, mashed potatoes, crème fraîche, mayonnaise, cream and light dough, e.g. cake mixture.

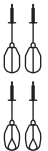
**Kneading hooks**

Suitable for stiff mixtures such as shortcrust pastry, yeast dough and potato dough as well as for mixing heavy mincemeat dough, pasta or bread dough.



Operation

⚠ Risk of injury!

Do not insert the mains plug until all preparations for working with the appliance are complete and the tools are firmly connected to the base unit. Never reach into the rotating tools. Only use tools of the same type in pairs.

→ Fig. 8

1. Completely unwind the mains cable.
2. Slide the desired tools into the respective suitable apertures until you hear them lock into place.
3. Place the ingredients into a suitable receptacle.
4. Plug into the mains.
5. Immerse the stirring whisks or kneading hooks into the mixture. Hold the bowl firmly with one hand.
6. Switch on at the required speed level:

Level 1: For working and mixing ingredients in

Level 4: For kneading and beating

M: For temporary maximum output, press to the left and hold.

7. Move the mixer to and fro in the bowl while mixing.
8. As soon as the desired consistency is achieved, set the switch to **0** and wait for the appliance to come to a stop. Only then should you remove the tool from the food.
9. Unplug the mains plug.
10. Press the ejector button and remove the tools.

Note: The ejector button can only be actuated if the switch is in the **0** position.

Care and daily cleaning

The appliance and the tools used must be thoroughly cleaned after each use.

⚠ Risk of electric shock!

- Unplug the appliance before cleaning it.
- Never immerse the base unit in liquids and do not clean in the dishwasher.
- Do not steam-clean the appliance.

Caution!

- Do not use any cleaning agents containing alcohol or spirits.
- Do not use any sharp, pointed or metal objects.
- Do not use abrasive cloths or cleaning agents.
- Wipe the outside of the base unit with a soft, damp cloth and dry off.
- Clean the tools with dishwashing detergent and a soft brush or place them into the dishwasher.
- Allow all parts to dry.

Recipes

Whipped cream

- 100-500 g whipping cream
- Using the stirring whisks, beat the cream for ½ to 5 minutes at level **4** until the desired consistency has been achieved.



Egg white/beaten egg white

- 1-5 egg whites
- Using the stirring whisks, beat the egg whites for 2 to 5 minutes at level **4**.



Sponge mixture

Basic recipe

- 2 eggs
- 2-3 tbsp hot water
- 100 g sugar
- 1 sachet vanilla sugar
- 70 g flour
- 70 g cornflour
- Baking powder if required



- Beat the ingredients (except flour and cornflour) with the stirring whisks for approx. 3-4 minutes at level **4** until frothy.
- Switch appliance to level **1**, mix in sifted flour and cornflour by the spoonful within ½ to 1 minute.

Maximum quantity: 2x basic recipe

Cake mixture

Basic recipe



- 2 eggs
- 125 g sugar
- 1 pinch of salt
- 1 sachet vanilla sugar or peel from ½ lemon
- 125 g butter or margarine (room temperature)
- 250 g flour
- 1 sachet baking powder
- 60 ml milk
- Mix all ingredients with the stirring whisks for approx. ½ minute at level **1**, and then for approx. 3-4 minutes at level **4**.

Maximum quantity: 2x basic recipe

Shortcrust pastry

Basic recipe



- 125 g butter (room temperature)
- 100-125 g sugar
- 1 egg
- 1 pinch of salt
- A little lemon peel or vanilla sugar
- 250 g flour
- Baking powder if required
- Mix all ingredients with the kneading hooks for approx. ½ minute at level **1**, then for approx. 3-4 minutes at level **4**.

Maximum quantity: 2x basic recipe

Base for fruit flan

Basic recipe



- 2 eggs
- 125 g sugar
- 125 g ground hazelnuts
- 50 g breadcrumbs
- Beat eggs and sugar for 3-4 minutes at level **4** until frothy.

- Switch appliance to level **1**, add hazelnuts and breadcrumbs and process for ½ minute with the stirring whisks.

Maximum quantity: 2x basic recipe

Plaited loaf

Basic recipe



- 250 g flour
- 1 sachet dried yeast
- 110 ml warm milk
- 1 egg
- 1 pinch of salt
- 40 g sugar
- 30 g melted, cooled butter
- Peel of half a lemon, grated
- Mix all ingredients with the kneading hooks for approx. ½ minute at level **1**, then for approx. 3-4 minutes at level **4**.

Maximum quantity: 2x basic recipe

Pizza dough

Basic recipe



- 250 g flour
- 1 sachet dried yeast
- 1 tsp sugar
- 1 pinch of salt
- 3 tbsp oil
- 125 ml warm water
- Mix all ingredients with the kneading hooks for approx. ½ minute at level **1**, then for approx. 3-4 minutes at level **4**.

Maximum quantity: 2x basic recipe

Bread dough

Basic recipe



- 250 g flour
- 8 g sugar
- 8 g margarine
- 4 g salt
- 1 sachet dried yeast
- 150 ml water
- Mix all ingredients with the kneading hooks for approx. ½ minute at level **1**, then for approx. 3-4 minutes at level **4**.

Maximum quantity: 2x basic recipe

处置



请以环保方式处置包装。

对本设备根据有关电气和电子设备报废的欧洲规定 2012/19/EU

(waste electrical and electronic equipment — WEEE) 进行标记。该规定管理在欧洲范围内对报废设备的回收和再生。

请咨询专业零售商, 了解可用的处置方式。

保修

该设备的保修条款将由售出国的销售代表来确定。您可向售出此设备的经销商详细了解这些条款。

当根据保修条款进行任何索赔时, 必须出具销售凭证或收据。

如有更改, 恕不另行通知。

Intended use

Read and follow the instruction manual carefully and keep for later reference! Enclose these instructions when you give this appliance to someone else.

If the instructions for correct use of the appliance are not observed, the manufacturer's liability for any resulting damage will be excluded.

This appliance is intended for domestic use only. Use the appliance only for processing normal amounts of food and for normal amounts of time for domestic use.

The appliance is suitable for stirring, beating and mixing soft foodstuffs and liquids, and for kneading soft dough. The appliance should not be used for processing other substances or objects.

This appliance can be used by persons with reduced physical, sensory or mental capabilities or lack of experience and/or knowledge if they have been given supervision or instruction concerning use of the appliance in a safe way and if they understand the hazards involved. Keep children away from the appliance and connecting cable and do not allow them to use the appliance. Do not let children play with the appliance. Cleaning and user maintenance must not be performed by children.

Safety instructions

Risk of electric shock and fire!

Only use the appliance indoors at room temperature and up to 2000 m above sea level. Do not place the appliance on or near hot surfaces, e.g. hobs.

Connect and operate the appliance only in accordance with the specifications on the rating plate. Do not use the appliance if the power cord and/or appliance are damaged. Only our customer service may repair the appliance, e.g. by replacing a damaged power cord, in order to avoid hazards. The mains cable must not come into contact with hot parts or be pulled across sharp edges. Never immerse the base unit in water or place it in the dishwasher. Do not steam-clean the appliance. Do not use the appliance with damp hands.

After each use, whenever the appliance is unsupervised, prior to assembly, prior to disassembly, prior to cleaning and in the event of an error, the appliance must always be disconnected from the mains.

⚠ Risk of injury!

Never connect the appliance to timer switches or remote-controllable sockets. If the power is interrupted, the appliance remains switched on and restarts when the power is restored. Switch off the appliance immediately. Never leave the appliance unattended while it is switched on! Never leave the appliance switched on for longer than is necessary to process the ingredients. Immediately after using the appliance, wait for it to stop. Before replacing accessories or additional parts which move during operation, the appliance must be switched off and disconnected from the power supply. Do not operate the appliance at idle speed. Keep hands clear of rotating parts. Protect long hair or loose items of clothing to prevent them from becoming caught in the rotating tools. Use the appliance only with genuine parts and accessories. Only insert tools of the same type (e.g. 2x kneading hooks) in pairs.

⚠ Risk of scalding!

Take care when processing hot food. Hot food may splash during processing.

⚠ Important!

It is essential to clean the appliance as described after each use or after it has not been used for an extended period. → *“Care and daily cleaning” see page 12*

Contents

Intended use.....	9
Safety instructions	9
Overview.....	11
Before using for the first time.....	11
Tools	11
Operation.....	12
Care and daily cleaning.....	12
Recipes.....	12
Disposal.....	14
Guarantee.....	14

Congratulations on the purchase of your new Bosch appliance. You can find further information about our products on our web page.

Country of origin:
Slovenia

Exclusive distributor:
BSH Home Appliances (China) Co., Ltd.
20/F,21/F, CN International Mansion,
129 Zhongshan Road, Nanjing,
Jiangsu Province, PRC.

Applicable standards:
GB 4706.1-2005
Safety of Household and Similar Electrical Appliances Part 1: General Requirements
GB 4706.30-2008
Safety of Household and Similar Electrical Appliances – Particular Requirements for Kitchen Machines

Careline:

4008855888

Service E-mail:

careline.china@bshg.com

Company website:

www.bosch-home.com

Technical specifications:

Electrical connection (voltage – frequency)	220-240 V~ 50/60 Hz
Power rating MFQCP..CN MFQCM..CN	375 W 400 W
Dimensions (H x W x D)	153 x 200 x 73 mm

These operating instructions refer to various models. An overview of the different models can be found on the illustrated pages.

→ Fig. 

Overview

→ Fig. 

Base unit

- 1 **Ejector button**
- 2 **On/Off switch (multi-level)**
 - a **0** = Appliance switched off
 - b **1** = Lowest speed
 - c **4** = Highest speed
 - d **M** = Instantaneous switching (highest speed)
- 3 **Mains cable**
- 4 **Apertures for inserting the tools**
 - a Large aperture (with 4 indentations)
 - b Small aperture

Tools*

- 5 **Stirring whisks** (x2)
- 6 **Turbo stirring whisks** (x2)
- 7 **Kneading hooks** (x2)
- 8 **Universal cutter***
(separate instruction manual)

* Depending on the model

With the universal cutter, you can use the appliance at full power. If the universal cutter is not included with the hand blender, it can be ordered from customer service (order no. 12011748).

Before using for the first time

Before the new appliance can be used, it must be fully unpacked, cleaned and checked.

Caution!

Never operate a damaged appliance!

- Remove the base unit and all accessories from the packaging.
- Remove the packaging material that is present.
- Check all parts for completeness.
→ Fig. 
- Inspect all parts for visible damage.
- Thoroughly clean and dry all parts before using for the first time.
→ “Care and daily cleaning” see page 12

Tools

Notes:

- The stirring whisks are not suitable for processing heavy dough.
- The maximum processing quantity is 500 g of flour and ingredients.

Stirring whisks or turbo stirring whisks depending on the model

Suitable for sauces, beaten egg whites, mashed potatoes, crème fraîche, mayonnaise, cream and light dough, e.g. cake mixture.

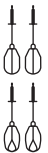

Kneading hooks

Suitable for stiff mixtures such as shortcrust pastry, yeast dough and potato dough as well as for mixing heavy mincemeat dough, pasta or bread dough.



Operation

Risk of injury!

Do not insert the mains plug until all preparations for working with the appliance are complete and the tools are firmly connected to the base unit. Never reach into the rotating tools. Only use tools of the same type in pairs.

→ Fig. 8

1. Completely unwind the mains cable.
2. Slide the desired tools into the respective suitable apertures until you hear them lock into place.
3. Place the ingredients into a suitable receptacle.
4. Plug into the mains.
5. Immerse the stirring whisks or kneading hooks into the mixture. Hold the bowl firmly with one hand.
6. Switch on at the required speed level:
 - Level 1:** For working and mixing ingredients in
 - Level 4:** For kneading and beating
 - M:** For temporary maximum output, press to the left and hold.
7. Move the mixer to and fro in the bowl while mixing.
8. As soon as the desired consistency is achieved, set the switch to **0** and wait for the appliance to come to a stop. Only then should you remove the tool from the food.
9. Unplug the mains plug.
10. Press the ejector button and remove the tools.

Note: The ejector button can only be actuated if the switch is in the **0** position.

Care and daily cleaning

The appliance and the tools used must be thoroughly cleaned after each use.

Risk of electric shock!

- Unplug the appliance before cleaning it.
- Never immerse the base unit in liquids and do not clean in the dishwasher.
- Do not steam-clean the appliance.

Caution!

- Do not use any cleaning agents containing alcohol or spirits.
- Do not use any sharp, pointed or metal objects.
- Do not use abrasive cloths or cleaning agents.
 - Wipe the outside of the base unit with a soft, damp cloth and dry off.
 - Clean the tools with dishwashing detergent and a soft brush or place them into the dishwasher.
 - Allow all parts to dry.

Recipes

Whipped cream

- 100-500 g whipping cream
- Using the stirring whisks, beat the cream for ½ to 5 minutes at level **4** until the desired consistency has been achieved.



Egg white/beaten egg white

- 1-5 egg whites
- Using the stirring whisks, beat the egg whites for 2 to 5 minutes at level **4**.



Sponge mixture

Basic recipe

- 2 eggs
- 2-3 tbsp hot water
- 100 g sugar
- 1 sachet vanilla sugar
- 70 g flour
- 70 g cornflour
- Baking powder if required
- Beat the ingredients (except flour and cornflour) with the stirring whisks for approx. 3-4 minutes at level 4 until frothy.
- Switch appliance to level 1, mix in sifted flour and cornflour by the spoonful within ½ to 1 minute.

Maximum quantity: 2x basic recipe

Cake mixture

Basic recipe

- 2 eggs
- 125 g sugar
- 1 pinch of salt
- 1 sachet vanilla sugar or peel from ½ lemon
- 125 g butter or margarine (room temperature)
- 250 g flour
- 1 sachet baking powder
- 60 ml milk
- Mix all ingredients with the stirring whisks for approx. ½ minute at level 1, and then for approx. 3-4 minutes at level 4.

Maximum quantity: 2x basic recipe

Shortcrust pastry

Basic recipe

- 125 g butter (room temperature)
- 100-125 g sugar
- 1 egg
- 1 pinch of salt
- A little lemon peel or vanilla sugar
- 250 g flour
- Baking powder if required
- Mix all ingredients with the kneading hooks for approx. ½ minute at level 1, then for approx. 3-4 minutes at level 4.

Maximum quantity: 2x basic recipe



Base for fruit flan

Basic recipe

- 2 eggs
- 125 g sugar
- 125 g ground hazelnuts
- 50 g breadcrumbs
- Beat eggs and sugar for 3-4 minutes at level 4 until frothy.
- Switch appliance to level 1, add hazelnuts and breadcrumbs and process for ½ minute with the stirring whisks.

Maximum quantity: 2x basic recipe

Plaited loaf

Basic recipe

- 250 g flour
- 1 sachet dried yeast
- 110 ml warm milk
- 1 egg
- 1 pinch of salt
- 40 g sugar
- 30 g melted, cooled butter
- Peel of half a lemon, grated
- Mix all ingredients with the kneading hooks for approx. ½ minute at level 1, then for approx. 3-4 minutes at level 4.

Maximum quantity: 2x basic recipe

Pizza dough

Basic recipe

- 250 g flour
- 1 sachet dried yeast
- 1 tsp sugar
- 1 pinch of salt
- 3 tbsp oil
- 125 ml warm water
- Mix all ingredients with the kneading hooks for approx. ½ minute at level 1, then for approx. 3-4 minutes at level 4.

Maximum quantity: 2x basic recipe



Bread dough

Basic recipe

– 250 g flour

8 g sugar

– 8 g margarine

– 4 g salt

– 1 sachet dried yeast

– 150 ml water

- Mix all ingredients with the kneading hooks for approx. ½ minute at level **1**, then for approx. 3-4 minutes at level **4**.

Maximum quantity: 2x basic recipe



Disposal



Dispose of packaging in an environmentally-friendly manner. This

appliance is labelled in accordance with European Directive 2012/19/EU concerning used electrical and electronic appliances (waste electrical and electronic equipment – WEEE).

The guideline determines the framework for the return and recycling of used appliances as applicable throughout the EU. Please ask your specialist retailer about current disposal facilities.

Guarantee

The guarantee conditions for this appliance are as defined by our representative in the country in which it is sold. Details regarding these conditions can be obtained from the dealer from whom the appliance was purchased. The bill of sale or receipt must be produced when making any claim under the terms of this guarantee.

Changes reserved.

Kundendienst – Customer Service

DE Deutschland, Germany

BSH Hausgeräte Service GmbH
Zentralwerkstatt für kleine Hausgeräte
Trautskirchener Strasse 6-8
90431 Nürnberg

Online Auftragsstatus, Filterbeutel-
Konfigurator und viele weitere Infos
unter: www.bosch-home.com

Reparaturservice, Ersatzteile &
Zubehör, Produkt-Informationen:
Tel.: 0911 70 440 040
mailto:cp-servicecenter@bshg.com

Wir sind an 365 Tagen rund um die Uhr
erreichbar.

AE United Arab Emirates, الإمارات العربية المتحدة

BSH Home Appliances FZE
Round About 13,
Plot Nr MO-0532A
Jebel Ali Free Zone – Dubai
Tel.: 04 881 4401
mailto:service.uae@bshg.com
www.bosch-home.com/ae

AL Republika e Shqipërisë, Albania

ELEKTRO-SERVIS sh.p.k
Rr. Shkëlqim Fusha, Selitë,
Pallati "Matrix Konstruktion",
Kati 0 dhe +1
1023 Tirane
Tel.: 4 2278 130, -131
Fax: 4 2278 130
mailto:info@elektro-servis.com

EXPERT SERVIS

Rruga e Kavajës,
Kulla B Nr 223/1 Kati I
1023 Tirane
Tel.: 4 480 6061
Tel.: 4 227 4941
Fax: 4 227 0448
Cel: +355 069 60 45555
mailto:info@expert-servis.al

AT Österreich, Austria

BSH Hausgeräte Gesellschaft mbH
Werkskundendienst für Hausgeräte
Quellenstrasse 2a
1100 Wien

Online Reparaturannahme,
Ersatzteile und Zubehör und viele
weitere Infos unter:
www.bosch-home.at
Reparaturservice, Ersatzteile & Zubehör,
Produktinformationen
Tel.: 0810 550 511
mailto:vie-stoerungsannahme@bshg.com

Wir sind an 365 Tagen rund um die Uhr für
Sie erreichbar.

AU Australia

BSH Home Appliances Pty. Ltd.
Gate 1, 1555 Centre Road
Clayton, Victoria 3168
Tel.: 1300 369 744*
Fax: 1300 306 818
mailto:aftersales.au@bshg.com
www.bosch-home.com.au

* Mo-Fr: 24 hours

BA Bosna i Hercegovina, Bosnia-Herzegovina

"HIGH" d.o.o.
Gradačanka 29b
71000 Sarajevo
Tel./Fax: 033 21 35 13
mailto:centralniserbis@yahoo.com

BE Belgique, België, Belgium

BSH Home Appliances S.A. – N.V.
Avenue du Laerbeek 74
Laarbeeklaan 74
1090 Bruxelles – Brussel
Tel.: 02 475 70 01
mailto:bru-repairs@bshg.com
www.bosch-home.be

BG Bulgaria

BSH Domakinski Uredi Bulgaria EOOD
Business center FPI, floor 5,
Cherni vrah Blvd. 51B
1407 Sofia
Tel.: 0700 208 17
mailto:informacia.servis-bg@bshg.com
www.bosch-home.bg

BH Bahrain, مملكة البحرين

Khalaifat Est.
P.O. Box 5111
Manama
Tel.: 01 7400 553
mailto:service@khalaifat.com

BY Belarus, Беларусь

ООО "БСХ Бытовая техника"
тел.: 495 737 2961
mailto:mok-kdhl@bshg.com

CH Schweiz, Suisse, Svizzera, Switzerland

BSH Hausgeräte AG
Bosch Hausgeräte Service
Fahrweidstrasse 80
8954 Geroldswil
Reparaturservice, Ersatzteile & Zubehör,
Produktinformationen
Tel.: 0848 888 200
mailto:ch-service@bshg.com
mailto:ch-spareparts@bshg.com
www.bosch-home.ch

CY Cyprus, Κύπρος

BSH Ikiakes Syskeves-Service
39, Arh. Makaariou III Str.
2407 Egomi/Nikosia (Lefkosia)
Tel.: 7777 8007
Fax: 022 658 128
mailto:bsh.service.cyprus@
cytanet.com.cy

CZ Česká Republika, Czech Republic

BSH domácí spotřebiče s.r.o.
Firemní servis domácích spotřebičů
Radlická 350/107c
158 00 Praha 5
Tel.: 0251 095 546
www.bosch-home.com/cz

DK Danmark, Denmark

BSH Hvidevarer A/S
Telegrafvej 4
2750 Ballerup
Tel.: 44 89 80 18
mailto:BSH-Service.dk@bshg.com
www.bosch-home.dk

EE Eesti, Estonia

SIMSON OÜ
Türi tn.5
11313 Tallinn
Tel.: 0627 8730
Fax: 0627 8733
mailto:serviceenet@serviceenet.ee
www.simson.ee

Renerki Kaubanduse OÜ
Tammisaare tee 134B (Euronicsi kaupluses)
12918 Tallinn
Tel.: 0651 2222
Fax: 0516 7171
mailto:kliiditeenindus@renerk.ee
www.renerk.ee

Eliser OÜ

Mustamäe tee 24
10621 Tallinn
Tel.: 0665 0090
mailto:hooldus@eliser.ee
www.kodumasinat-remont.ee

ES España, Spain

BSH Electrodomésticos España S.A.
Servicio Oficial del Fabricante
Parque Empresarial PLAZA,
C/ Manfredonia, 6
50197 Zaragoza
Tel.: 976 305 713
Fax: 976 578 425
mailto:CAU-Bosch@bshg.com
www.bosch-home.es

FI Suomi, Finland

BSH Kodinkoneet Oy
Itälähdenkatu 18 A, PL 123
00201 Helsinki
Tel.: 0207 510 705
mailto:Bosch-Service-FI@bshg.com
www.bosch-home.fi
Soittajainta on kiinteästä verkosta ja
matkapuhelimesta 8,35 snt/puh + 16,69 snt/min.

FR France

BSH Electroménager S.A.S.
50 rue Ardoin – CS 50037
93406 SAINT-OUEN cedex
Service interventions à domicile:
01 40 10 11 00

Service Consommateurs:

0 892 698 010 Service 0,40 € / min
+ prix appel

mailto:soa-bosch-conso@bshg.com
Service Pièces Détachées et
Accessoires:

0 892 698 009 Service 0,40 € / min
+ prix appel

www.bosch-home.fr

GB Great Britain

BSH Home Appliances Ltd.
Grand Union House
Old Wolverton Road
Wolverton
Milton Keynes MK12 5PT
To arrange an engineer visit, to order
spare parts and accessories or for
product advice please visit
www.bosch-home.co.uk
or call Tel.: 0344 892 8979*

* Calls are charged at the basic rate, please
check with your telephone service provider
for exact charges.

GR Greece, Ελλάδα

BSH Ikiakes Siskeves A.B.E.
 Central Branch Service
 17 km E.O. Athinon-Lamias & Potamou 20
 14564 Kifisia
 Τηλέφωνο: 181 82
 Τηλέφωνο: 210 427 77 01
 mailto:nkf-CustomerService@bshg.com
 www.bosch-home.gr

HK Hong Kong, 香港

BSH Home Appliances Limited
 Unit 1 & 2, 3rd Floor,
 North Block, Skyway House,
 3 Sham Mong Road
 Tai Kok Tsui, Kowloon
 Hong Kong
 Tel.: 2626 9655 (HK)
 Toll free 0800 863 (Macao)
 Fax: 2565 6681
 mailto:bosch.hk.service@bshg.com
 www.bosch-home.com.hk

HR Hrvatska, Croatia

BSH kućanski uređaji d.o.o.
 Ulica grada Vukovara 269F
 10000 Zagreb
 Tel.: 01 5520 888
 Fax: 01 6403 603
 mailto:informacije.servis-hr@bshg.com
 www.bosch-home.com/hr

HU Magyarország, Hungary

BSH Háztartási Készülék Kereskedelm Kft.
 Árpád fejedelem útja 26-28
 1023 Budapest
 Call Center: +06 80 200 201
 mailto:BSH-szerviz@bshg.com
 www.bosch-home.com/hu

IE Republic of Ireland

BSH Home Appliances Ltd.
 M50 Business Park
 Ballymount Road Upper
 Walkinstown
 Dublin 12
 To arrange an engineer visit, to order
 spare parts and accessories or for
 product advice please call
 Tel.: 01450 2655*
 www.bosch-home.ie
 * Calls are charged at the basic rate, please
 check with your telephone service provider
 for exact charges

IL Israel

C/S/B/ Home Appliance Ltd.
 1, Hamasger St.
 North Industrial Park
 Lod, 7129801
 Tel.: 08 9777 222
 Fax: 08 9777 245
 mailto:csb-serv@csb-ltd.co.il
 www.bosch-home.co.il

IN India, Bhārat, भारत

BSH Household Appliances Mfg. Pvt. Ltd.
 Arena House, Main Bldg, 2nd Floor,
 Plot No. 103, Road No. 12,
 MIDC, Andheri East
 Mumbai 400 093
 Toll Free 1800 266 1880*
 www.bosch-home.com/in
 * Mo-Sa: 8.00am to 8.00pm
 (exclude public holidays)

IS Iceland

Smith & Norland hf.
 Noatuní 4
 105 Reykjavik
 Tel.: 0520 3000
 Fax: 0520 3011
 www.sminor.is

IT Italia, Italy

BSH Elettrodomestici S.p.A.
 Via. M. Nizzoli 1
 20147 Milano (MI)
 Tel.: 02 412 678 100
 mailto:info.it@bosch-home.com
 www.bosch-home.com/it

KZ Kazakhstan, Қазақстан

IP Anackiy A.N. PTN-Service
 Kuysiy Dina str.23/1 N3
 Astana
 Tel.: 717 236 64 55
 mailto:ptnservice@mail.ru
 Technodom Service
 Utegen Batira Str. 73
 480096 Almaty
 Tel.: 727 258 85 44
 mailto:lsr@technodom.kz
 www.technodom.kz
 Kombitehnocentr
 Zhambyl st. 117
 480096 Almaty
 Tel.: 727 338 45 55
 mailto:cts_pavel@bk.ru
 www.cts.kz

TOO Evrika Service
 Shimkent, Riskulova 22.
 Shimkent 160018
 Tel.: 727 252 44 63 75
 mailto:evrika_c@mail.ru
 www.evrika.com

AV SERVICE

Abulhair hana Str. 51
 Uralsk 090000
 Tel.: 711 293 99 49
 mailto:oastafiev@avservice.kz
 www.avservice.kz

LB Lebanon, لبنان

Teheni, Hana & Co.
 Boulevard Dora 4043 Beyrouth
 P.O. Box 90449
 Jdeideh, 1202 2040
 Tel.: 01 255 211
 mailto:Info@Teheni-Hana.com

LT Lietuva, Lithuania

Senuku prekybos centras UAB
 Jonavos g. 62
 44192 Kaunas
 Tel.: 037 212 146
 Fax: 037 212 165
 www.senukai.lt

UAB "AG Service"
 R. Kalantos g. 32
 52494 Kaunas
 Tel.: 0700 556 55
 Fax: 037 331 363
 mailto:servisas@agservice.lt
 www.agservice.lt

Baltic Continent Ltd.
 Lukšio g. 23
 09132 Vilnius
 Tel.: 870 055 595
 Fax: 052 741 722
 mailto:info@balticcontinent.lt
 www.balticcontinent.lt

UAB Emtoservis

Savanorių pr. 1 (Centrinė būstinė)
 03116 Vilnius
 Tel.: 870 044 724
 Fax: 052 737 368
 mailto:svc@emtoservis.lt
 www.emtoservis.lt

LU Luxembourg

BSH électroménagers S.A.
 13-15, ZI Breedeweues
 1259 Senningerberg
 Tel.: 26 349 811
 Fax: 26 349 315
 Reparaturen: lux-repair@bshg.com
 Ersatzteile: lux-spare@bshg.com
 www.bosch-home.com/lu

LV Latvija, Latvia

SIA "General Serviss"
 Buļļu iela 70c
 1067 Riga
 Tel.: 067 42 52 32
 mailto:info@serviscentrs.lv
 www.serviscentrs.lv
 BALTIJAS SERVISS
 Brīvības gatve 201
 1039 Riga
 Tel.: 067 07 05 20; -36
 Fax: 067 07 05 24
 mailto:info@baltijasserviss.lv
 www.baltijasserviss.lv

Sia Elektronika-Serviss

Tadaikų iela 4
 1004 Riga
 Tel.: 067 71 70 60
 Fax: 067 60 12 35
 mailto:serviss@elektronika.lv
 www.elektronika.lv

MD Moldova

S.R.L. "Rialto-Studio"
 ул. Щуцева 98
 2012 Кишинев
 тел./ факс: 022 23 81 80
 mailto:bosch-md@mail.ru

ME Crna Gora, Montenegro

Elektronika komerc
 Oktobarske revolucije 129
 81000 Podgorica
 Tel./Fax: 020 674 631
 Mobil: 069 324 812
 mailto:ekobosch.servis@t-com.me

MK Macedonia, Македонија

GORENEC
 Jane Sandanski 69 lok. 3
 1000 Skopje
 Tel.: 02 2454 600
 Mobil: 070 233 689
 mailto:goreniec@yahoo.com

MT Malta

Oxford House Ltd.
 Notabile Road
 Mriehel BKR 14
 Tel.: 021 442 334
 Fax: 021 488 656
 www.oxfordhouse.com.mt

MV Raajjeyge Jumhooriyyaa, Maldives

Lintel Investments
Ma. Maadheli, Majeedhee Magu
Malé
Tel.: 0331 0742
mailto:mohamed.zuhuree@
lintel.com.mv

NL Nederlande, Netherlands

BSH Huishoudapparaten B.V.
Taurus Avenue 36
2132 LS Hoofddorp
Storingsmelding:
Tel.: 088 424 4010
Fax: 088 424 4845
mailto:bosch-contactcenter@
bshg.com
Onderdelenverkoop:
Tel.: 088 424 4010
Fax: 088 424 4801
mailto:bosch-onderdelen@bshg.com
www.bosch-home.nl

NO Norge, Norway

BSH Husholdningsapparater A/S
Grensesvingen 9
0661 Oslo
Tel.: 22 66 05 54
Tel.: 22 66 06 00
mailto:Bosch-Service-NO@bshg.com
www.bosch-home.no

NZ New Zealand

BSH Home Appliances Ltd.
Unit F 2, 4 Orbit Drive
Mairangi Bay
Auckland 0632
Tel.: 0800 245 700*
Fax: 0800 256 535
mailto:aftersales.nz@bshg.com
www.bosch-home.co.nz
* Mo-Fr: 8.30 am to 5.00 pm
(exclude public holidays)

PL Polska, Poland

BSH Sprzęt Gospodarstwa
Domowego sp. z o.o.
Al. Jerozolimskie 183
02-222 Warszawa
Centrala Serwisu
Tel.: 801 191 534
Fax: 022 572 7709
mailto:Serwis.Fabryczny@bshg.com
www.bosch-home.pl

PT Portugal

BSHP Electrodomesticos,
Sociedade Unipessoal, Lda.
Rua Alto do Montijo, nº 15
2790-012 Carnaxide
Tel.: 214 250 730
Fax: 214 250 701
mailto:bosch.electrodomesticos.pt@
bshg.com
www.bosch-home.pt

RO România, Romania

BSH Electrocasnice srl.
Sos. Bucuresti-Ploiesti,
nr. 19-21, sect.1
13682 Bucuresti
Tel.: 021 203 9748
Fax: 021 203 9733
mailto:service.romania@bshg.com
www.bosch-home.ro

RU Russia, Россия

ООО «БСХ Бытовые Приборы»
Сервис от производителя
Малая Калужская, 15
119071 Москва
Тел.: 8 (800) 200 29 61
mailto:mok-kdhl@bshg.com
www.bosch-home.com

SA Kingdom Saudi Arabia,

المملكة العربية السعودية
Abdul Latif Jameel Electronics
and Airconditioning Co. Ltd.
BOSCH Service centre,
Kilo 5 Old Makkah Road
(Next to Toyota), Jamiah Dist.
P.O.Box 7997
Jeddah 21472
Tel.: 800 127 9999
mailto:palakkaln@alj.com
www.aljelectronics.com.sa

SE Sverige, Sweden

BSH Home Appliances AB
Landsvägen 32
169 29 Solna
Tel.: 0771 19 70 00 local rate
Tel.: 0771 11 22 77 local rate
mailto:Bosch-Service-SE@bshg.com
www.bosch-home.se

SG Singapore, 新加坡

BSH Home Appliances Pte. Ltd.
Block 4012, Ang Mo Kio Avenue 10
#01-01 Techplace 1
Singapore 569628
Tel.: 6751 5000*
Fax: 6751 5005
mailto:bshsgp.service@bshg.com
www.bosch-home.com.sg
* Mo-Fr: 8.30am to 7.00pm, Sa: 8.30am to 5.30pm
(exclude public holidays)

SI Slovenija, Slovenia

BSH Hišni aparati d.o.o.
Litostrojska 48
1000 Ljubljana
Tel.: 01 583 07 00
Fax: 01 583 08 89
mailto:informacije.servis@bshg.com
www.bosch-home.com/si

SK Slovensko, Slovakia

BSH domácí spotřebiče s.r.o.
Firemní servis domácích spotřebičů
Radlická 350/107c
158 00 Praha 5
Tel.: +421 244 452 041
mailto:opravy@bshg.com
www.bosch-home.com/sk

TH Thailand, ประเทศไทย

BSH Home Appliances Limited
Ital Thai Tower, 2034/31-39, 1st floor,
New Petchburi Road
Bangkapi, Huay Kwang
Bangkok, 10310
Tel.: 02 975 5353*
www.bosch-home.com/th
* Mo-Sa: 8.00am to 6.00pm
(exclude public holidays)

TR Türkiye, Turkey

BSH Ev Aletleri Sanayi
ve Ticaret A.Ş.
Fatih Sultan Mehmet Mahallesi
Balkan Caddesi No: 51
34771 Ümraniye, İstanbul
Tel.: 0 216 444 6333*
Fax: 0 216 528 9188*
mailto:careline.turkey@bshg.com
www.bosch-home.com/tr
* Çağrı merkezini sabit hatlardan
aramanın bedelli şehir içi ücretlendirmesi,
cep telefonlarından ise kullanılan
tarifeye göre değişiklik göstermektedir

TW Taiwan, 台灣

我們期盼您不斷的鼓勵與指導,
任何諮詢或服務需求,
歡迎洽詢客服專線
BSH Home Appliances Private Limited
台北市內湖區洲子街80號11樓
11F., No.80, Zhouzi St., Neihu Dist.
Taipei City 11493
Tel.: 0800 368 888
Fax: 02 2627 9788
mailto:bshntzn-service@bshg.com
www.bosch-home.com.tw

UA Ukraine, Україна

ТОВ "БСХ Побутова Техніка"
tel.: 044 490 2095
mailto:bsh-service.ua@bshg.com
www.bosch-home.com.ua

XK Kosovo

Service-General SH.P.K.
rr.Magjistralia Ferizaj Prishtine
70000 Ferizaj
Tel : 00381 (0) 290 330 723
Tel.: 00377 44 172 309
mailto:servicegeneral527@gmail.com

XS Srbija, Serbia

BSH Kućni aparati d.o.o.
Milutina Milankovića br. 9ž
11070 Novi Beograd
Tel.: 011 353 70 08
Fax: 011 205 23 89
mailto:informacije.servis-sr@
bshg.com
www.bosch-home.rs

ZA South Africa

BSH Home Appliances (Pty) Ltd.
15th Road Randjespark
Private Bag X36, Randjespark
1685 Midrand – Johannesburg
Tel.: 086 002 6724
Fax: 086 617 1780
mailto:applianceserviceza@bshg.com
www.bosch-home.com/za

Robert Bosch Hausgeräte GmbH

Carl-Wery-Straße 34

81739 München

GERMANY

www.bosch-home.com



8001102351

(980903)

A

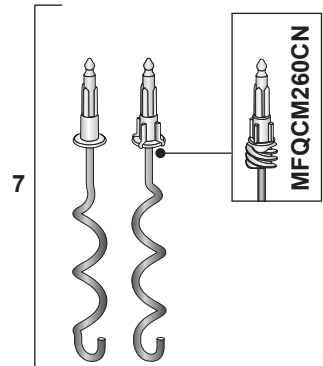
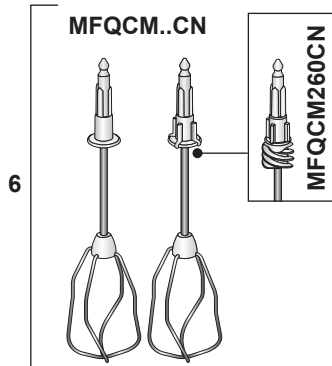
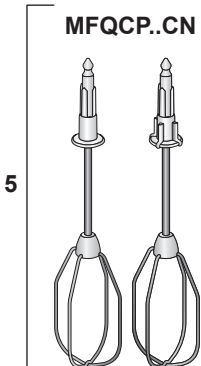
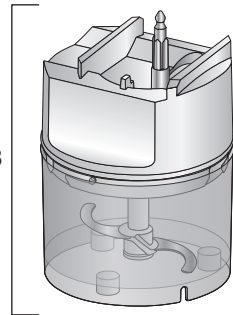
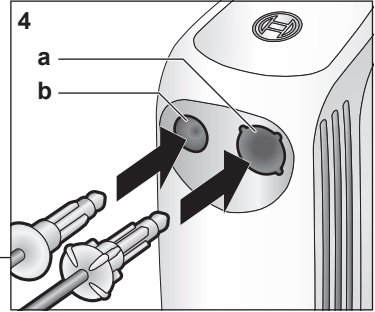
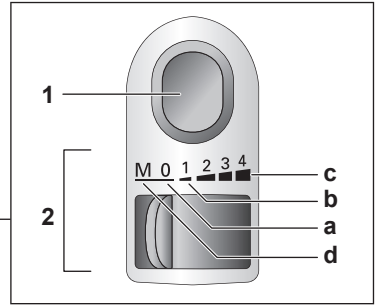
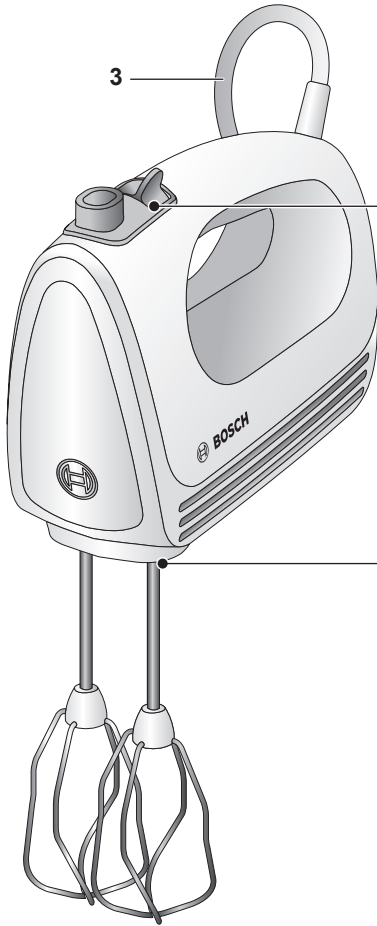

B

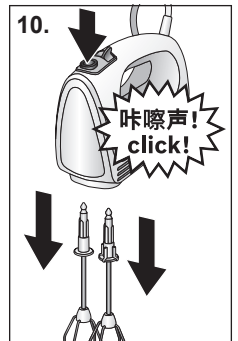
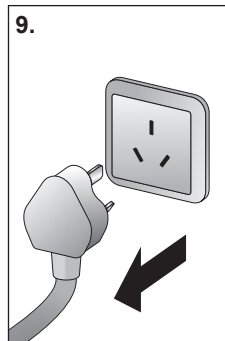
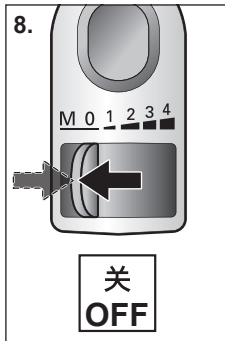
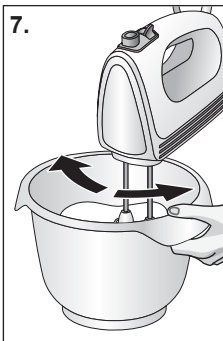
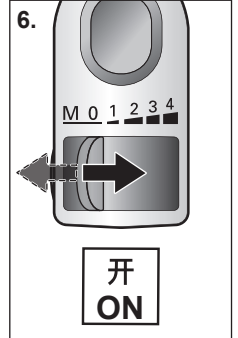
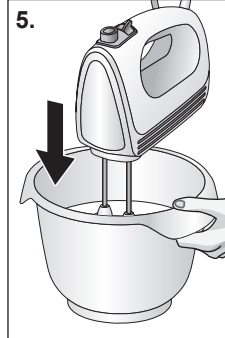
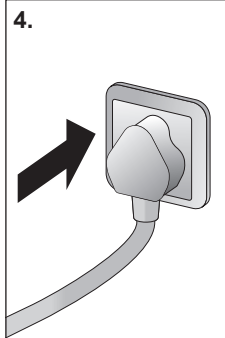
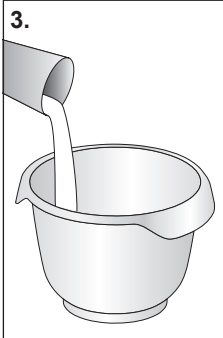
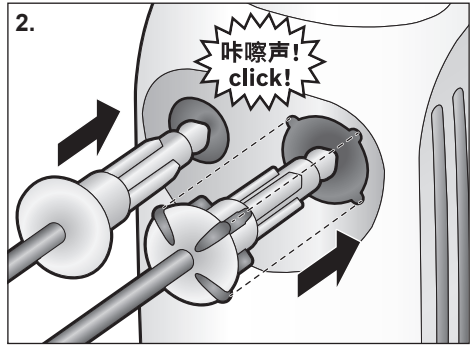
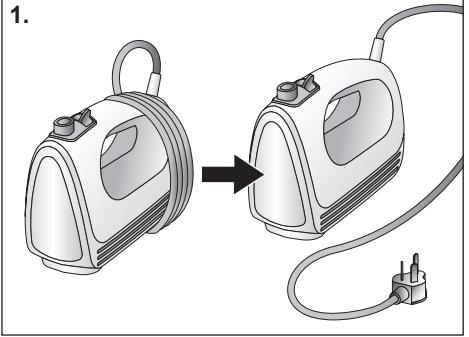
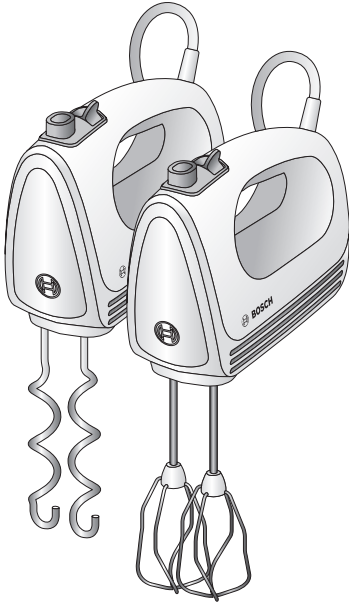

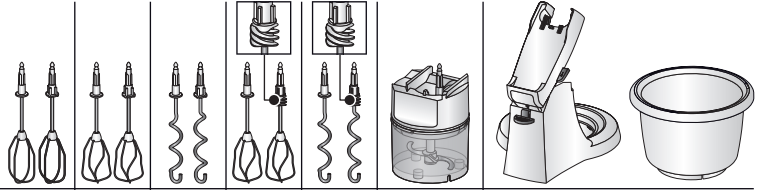
C**MFQCP100CN****MFQCM20BCN****MFQCM20RCN****MFQCM260CN**